



Brickendon Liberty Parish

Map of Brickendon Liberty and its rights of way

With funding from the Parish Paths Partnership and the Hertfordshire Environmental Landfill Partnership, the Parish Council produced and distributed free to all residents a map of Brickendon Liberty Parish and its rights of way. It is still available to all newcomers to the Parish. www.brickendon-liberty.org.uk

Celtic Harmony Camp

Nestling in Bourne Woods just off Brickendon Lane, Celtic Harmony is a not-for-profit organisation promoting a more sustainable way of life through natural and cultural heritage education for children and adults.

For more details see www.celticharmony.org

Brickendon Parish Environmental Action Plan (PEAP)

The Parish Environmental Action Plan sets out specific plans and actions that have been, and will be, undertaken to maintain and enhance the environment in the parish. This has included improvements to the wildlife habitat on Brickendon village green.

For more details see www.brickendon-liberty.org.uk



Countryside Management Service

CMS works with communities across Hertfordshire to help them care for and enjoy their environment. Locally CMS supports voluntary activity within the National Nature Reserve through the work of the Wood Wardens and their Wednesday volunteers.

Broxbourne Woods National Nature Reserve (NNR)

Hertfordshire's only NNR is managed by a partnership of organisations including: The Woodland Trust, which owns and manages Wormley and Hoddesdonpark Woods, Countryside Management Service, which manage Broxbourne and Bencroft Woods on behalf of Hertfordshire County Council and Herts and Middlesex Wildlife Trust which manage nearby Danemead. The NNR is organised according to a shared management plan agreed with Natural England, the Government advisors on conservation and rural matters.

HERTFORD

HERTFORD HEATH

Broxbourne Woods Area Conservation Society

The aims and objectives of the Broxbourne Woods Area Conservation Society are to: Act as guardians to protect and preserve the Broxbourne Woods area.

Maintain close contact with county planners, in order to prevent, as far as possible, undesirable developments taking place.

Encourage more people to enjoy the peace and tranquillity of this National Nature Reserve.

Great Groves

A detached part of the Broxbourne Woods complex, this 18.2ha site is privately owned and managed. It is mainly semi-natural woodland mostly oak and ash with hornbeam underlay.

For more details see www.greatgroves.co.uk

HODDESDON

Broxbourne Trust for Open Spaces

The trust, formed by the Broxbourne and Hoddesdon Open Spaces and Recreation Grounds Act 1890, exists to protect, care for and regulate certain areas of common land, some of which now lie in Brickendon Liberty Parish. These include strips of land on either side of White Stubbs Lane, Broxbourne Common and Emmanuel Pollards.

BROXBOURNE DISTRICT

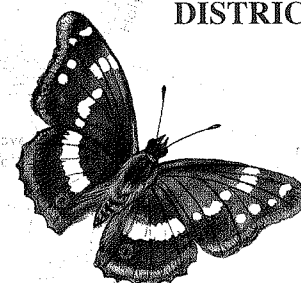

 **Ordnance Survey**

Ordnance Survey C. Crown Copyright all rights reserved. licence number W9629



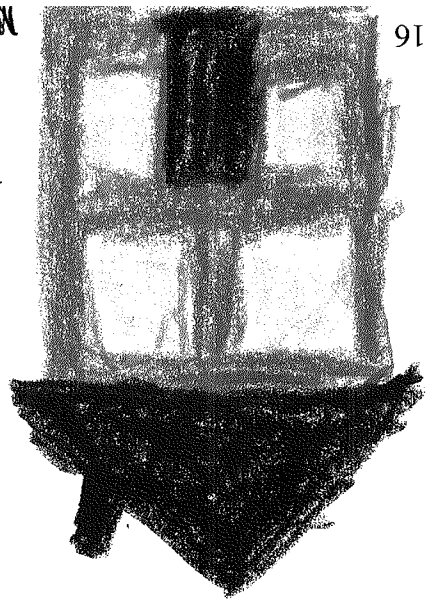
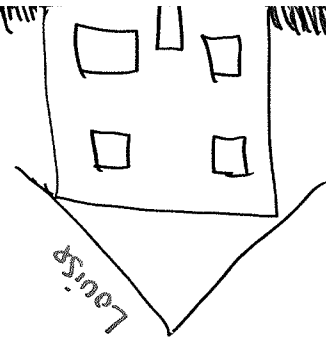
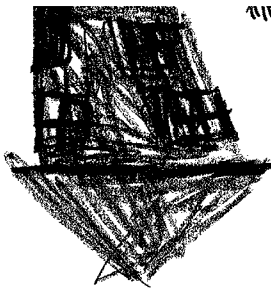
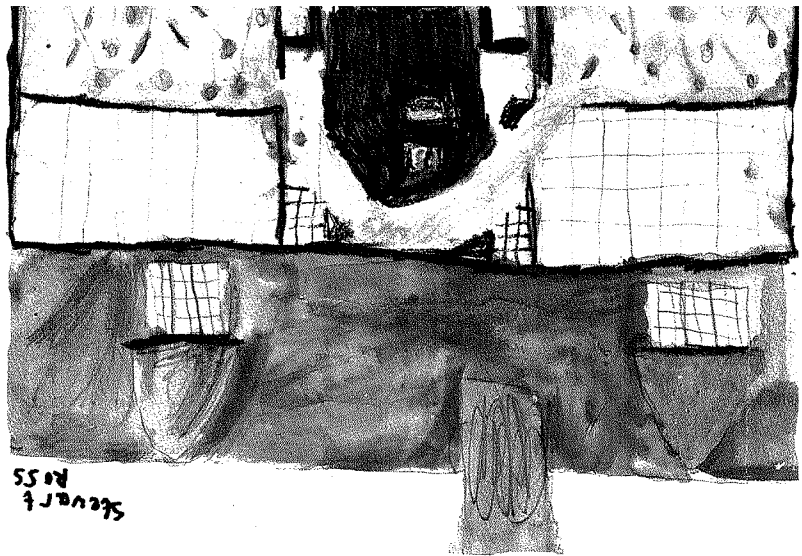

Bearing in mind the East of England Plan requirement, 41% of the respondents considered that the parish could accommodate more houses (up to a maximum of 30) compared with 59% who thought it should not.

Conversions to provide extra dwellings were most acceptable, particularly of very large houses in the parish and of obsolete barns. Most people would be happy to see a limited number of affordable, cheap, carefully planned houses, limited in size. Some infilling was also acceptable. There was a call for sheltered accommodation and a residential home for elderly people enabling those living in the parish to continue to do so.

Housing

33

How environmentally green is our parish? Not nearly as green as most want it to be! With 92% supporting an increase in domestic waste recycling and almost as many saying that they would use a local recycling bank as well as the household recycling collections, there is clearly a demand in the parish that is not yet fully met. Very few actually use green energy (4%) but many want to know much more about how to achieve this, with 73% saying that they would consider installing some sort of green energy option and applying for a grant to do so. 64% would consider joining a local green energy co-operative venture. Of the alternative energy sources listed, solar was most popular followed by wind and geo-thermal.

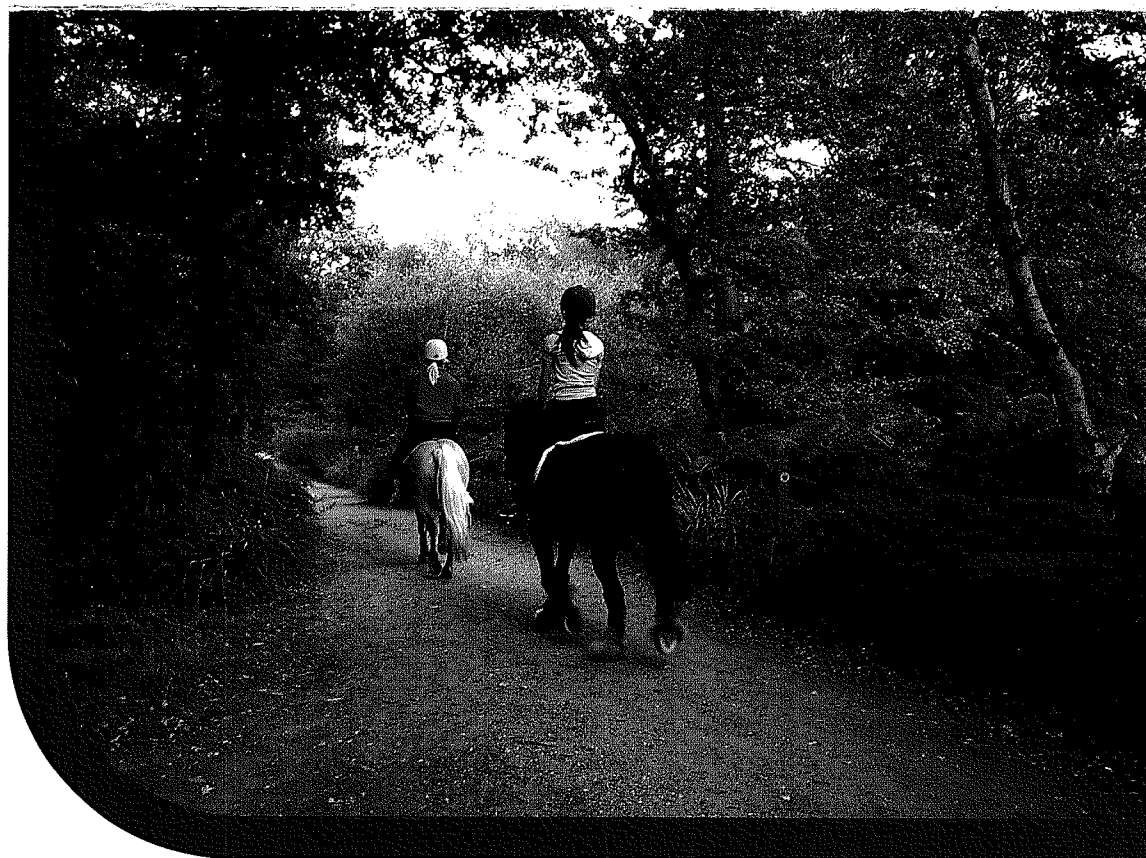

Actions

- Green energy options are to be explored and the viability of a community energy project to be assessed.
- Continue to support the organisations protecting the parish's woodlands from development.
- Work towards facilitating safer off road access to woods and nearby towns for both walkers and cyclists.
- Campaign for the Parish Council to have greater influence within the planning application vetting process.
- Discuss with East Herts District Council improved facilities for collecting and re-cycling a greater range of household items